

## MINI LATHE BED EXTENSION for # 70-105 Lathe

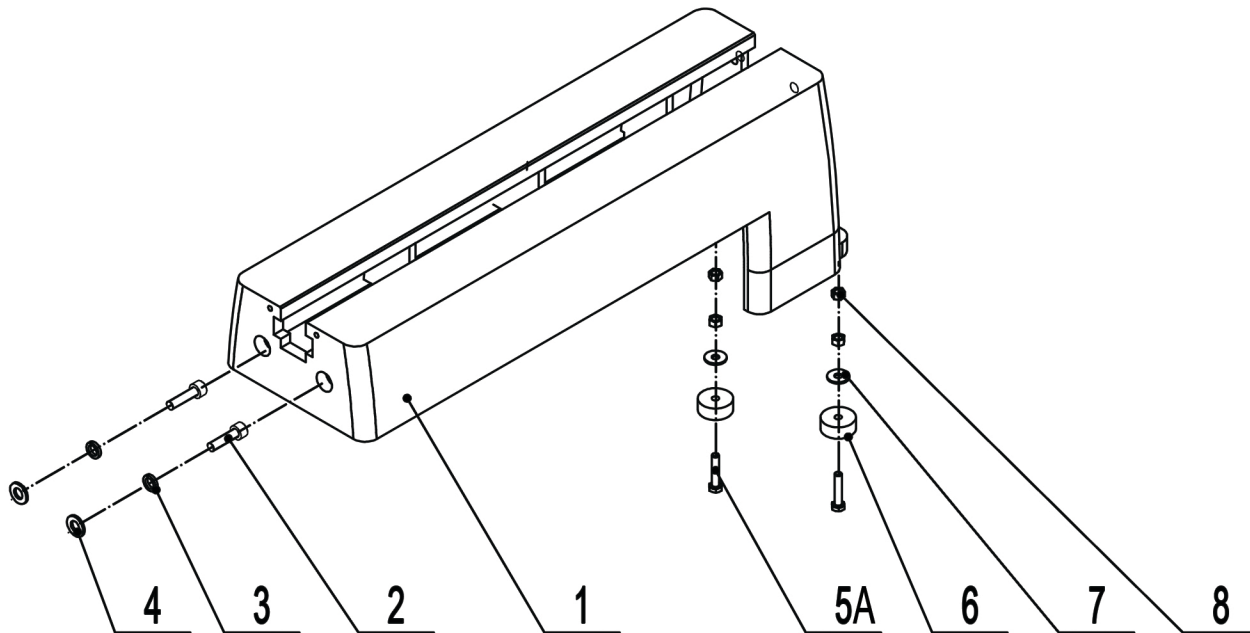

KEY NO.	DESCRIPTION	QTY	MFG. PART NO.
1	Lathe Bed Extension	1	P70-906-1
2	Hexagon Bolt - M10x20	2	P70-906-2
3	Lock Washer - M10	2	P70-906-3
4	Flat Washer - M10	2	P70-906-4
5A	Hexagon Bolt - M8x40	2	P70-105-63
6	Rubber Foot	2	P70-105-62
7	Big Washer - M8	2	P70-105-61
8	Nut - M8	4	P70-105-41A

### Tools Required for Assembly

- \* 17mm or Adjustable Wrench
- \* 8mm Hex Wrench

### To Install:

Match the bed extension to the end of the lathe bed. Insert the two bolts (Part #2) with the two lock washers (#3) and two flat washers (#4) through the two holes at the end of the bed extension into the threaded holes in the lathe bed end. Hand tighten the two bolts and level the bed extension to the lathe bed by using a straight edge that is set onto the top of the bed casting.

Align the bed rails (Left or Right) by using a straight edge inside the bed channel. This ensures that the tailstock will float freely without jamming. Tighten the two bolts after the bed extension is level and in line with the lathe.

**NOTE:** The 70-105 Bed Extension is supplied with rubber feet for use on a bench. To permanently mount the lathe and extension on a bench, use the mounting holes in the bases. Remove the rubber feet and insert 1" to 1-1/4" thick spacers (the rubber feet or washers, bushings, wood strips) under the casting when screwing or bolting the machine down (mounting hardware is not provided). **NOTE:** The lathe's TEFC motor requires 1" extra space below the bed to allow airflow and room to pivot the motor down for belt changes.

For mounting on a stand, the spacers may not be needed if the lathe's motor can swing free below the bed casting when mounted on the stand plate.