



## Assembly Instructions and Parts List

# Stand Extension for JWL-1015/1015VS Lathes

Stock No. 719103A

**⚠WARNING** Read and understand the entire owner's manual that accompanied your JWL-1015 lathe before attempting assembly or operation of accessories.

Inspect contents for shipping damage. Report any damage or part shortages to your distributor. Do not discard shipping materials until accessory is set up and functioning properly.

### Shipping contents

- 1 Cross bar
- 1 Leg
- 1 Bracket
- 2 Tube caps
- 2 Levelers with hex nut
- 1 Hardware package, includes:
  - 2 Socket head cap screws, 5/16x3/4
  - 2 Lock washers, 5/16
  - 2 Flat washers, 5/16
  - 6 Socket head cap screws, M8x80
  - 8 Flat washers, 8mm
  - 2 Hex nuts, M8

### Tools required for assembly

6mm hex key ("Allen wrench")  
Open-end wrenches, 13mm (1/2"); 14mm (9/16")

### Assembly

Refer to exploded view on reverse side for parts clarification. Bracketed numbers refer to index numbers in exploded view.

Refer to documents M-719101 and M-719102A for instructions on assembling optional Bed Extension and Stand to lathe.

1. Install two levelers [5] into bottom of leg. Levelers can be adjusted for height and leveling of lathe. Tighten hex nut against leg to secure setting.
2. Install cross bar [4] to middle set of holes with screws and washers [7/8]. Make screws snug but *do not fully tighten yet*.

3. Install bracket [1] onto leg with screws, washers, and nuts [7/8/9]. Gussets on bracket should face inward. Multiple holes allow adjustment of lathe height. Make nuts snug but *do not fully tighten yet*.
4. Place lathe with extension bed onto stand brackets, and secure with screws and washers [10/11/12]. Insert all screws first, then tighten each securely.
5. Fully tighten all screws and nuts in cross bar [4] and bracket [1].



Stock no.	719103A
Assembled dimensions (WxDxH) approx. 680 x 584 x 800 mm (21 x 23 x 31-1/2 in.) <i>Stand with extension: 1213 x 584 x 800 mm (47-3/4 x 23 x 31-1/2 in)</i>	
Shipping dimensions (WxDxH) approx. 790 x 660 x 200 mm (31.1 x 26 x 7.9 in)	
Net weight (approx.): 10 kg (22 lbs)	
Shipping weight (approx.): 13 kg (28.6 lbs)	

**JET**  
427 New Sanford Road  
LaVergne, Tennessee 37086  
Ph.: 800-274-6848  
www.jettools.com

**Manual No. M-719103A**  
Edition 2 11/2018  
Copyright © 2017 JET, a Division of JPW Industries, Inc.

## # 719103A Stand extension for JWL-1015/1015VS lathes

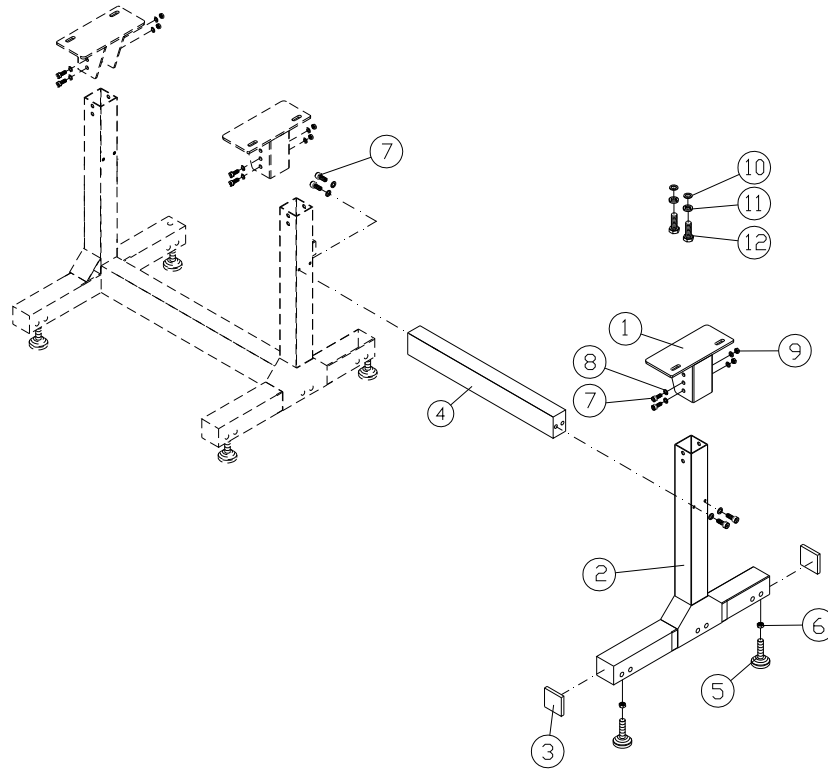

Index No	Part No	Description	Size	Qty
1	JWL1221VSS-101	Bracket		1
2	JWL1221VSS-102	Leg		1
3	JWL1221VSS-103	Tube Cap		2
4	JWL1015S-204	Cross Bar		1
5	JWL1642-206	Leveler		2
6	TS-0561031	Hex Nut	3/8"-16	2
7	F005415	Hex Socket Hd Cap Screw *	M8-1.25 x 80	6
8	TS-1550061	Flat Washer *	M8	8
9	TS-1540061	Hex Nut *	M8	2
10	TS-0680031	Flat Washer *	5/16"	2
11	TS-0720081	Lock Washer *	5/16"	2
12	TS-0208041	Socket Head Cap Screw *	5/16"-18x 3/4"	2
	JWL1015S-HP	Hardware Package (includes items with *)		

Note: Hardware package may include extra fasteners.

To order parts or reach our service department, call 1-800-274-6848 Monday through Friday, 8:00 a.m. to 5:00 p.m. CST. Having the Model Number and Serial Number of your machine available when you call will allow us to serve you quickly and accurately. Non-proprietary parts, such as fasteners, can be found at local hardware stores, or may be ordered from JET.

**⚠ WARNING:** This product can expose you to chemicals including lead and cadmium which are known to the State of California to cause cancer and birth defects or other reproductive harm, and phthalates which are known to the State of California to cause birth defects or other reproductive harm. For more information go to <http://www.p65warnings.ca.gov>.

**⚠ WARNING:** Drilling, sawing, sanding or machining wood products generates wood dust and other substances known to the State of California to cause cancer. Avoid inhaling dust generated from wood products or use a dust mask or other safeguards for personal protection.

Wood products emit chemicals known to the State of California to cause birth defects or other reproductive harm. For more information go to <http://www.p65warnings.ca.gov/wood>.