

Woodpeckers®

SUPER FENCE

OWNER'S MANUAL

If you think you're missing anything, email us at mailroom@woodpeck.com.
You can also call us at 800-752-0725 from 9:00 a.m. to 5:00 p.m. EST Monday - Friday.

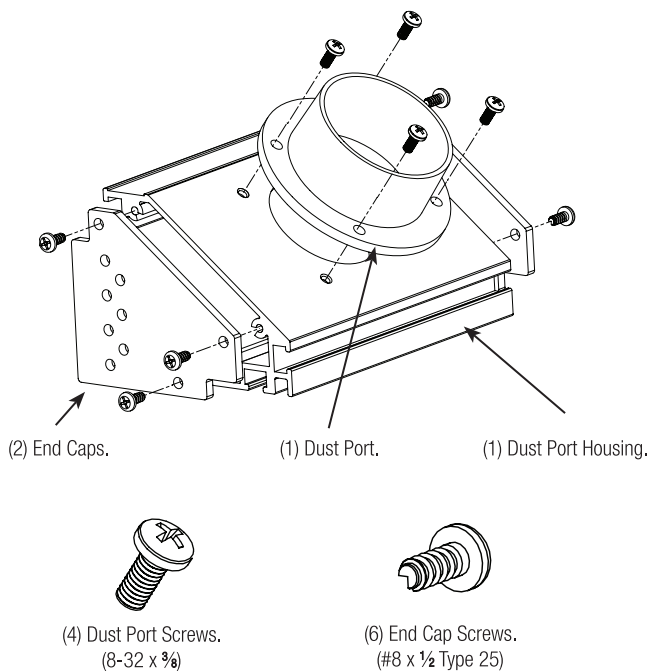

STEP 1: Assembling the Dust Port Housing.

Attach the dust port using (4) Dust Port Screws. Then use (3) End Cap Screws to attach each End Cap. Install screws loosely at first until all are started. Then tighten all.

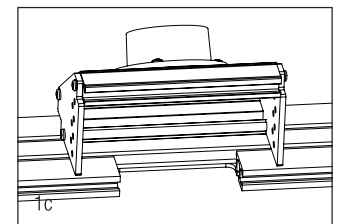
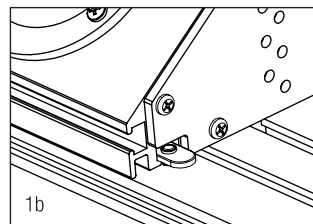
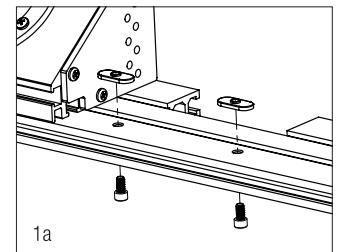
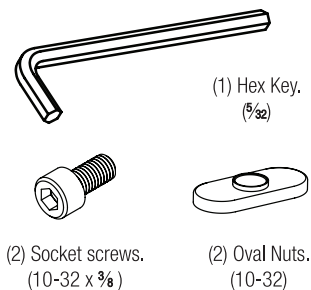

STEP 2: Installing the Dust Port Housing.

One side of the base fence has two slots, the other has three. The two slot side goes up.

(1a) Insert one socket screw up through the base fence right behind the square cut out. Start an oval nut on to the screw. Repeat the process for the second screw and oval nut.

(1b) Slide the assembled Dust Port Housing over the oval nuts.

(1c) Center the Dust Port Housing over the square cut out and flush against the back edge of the base fence. Now tighten both socket screws.

STEP 3: Install the Infeed Bracket.

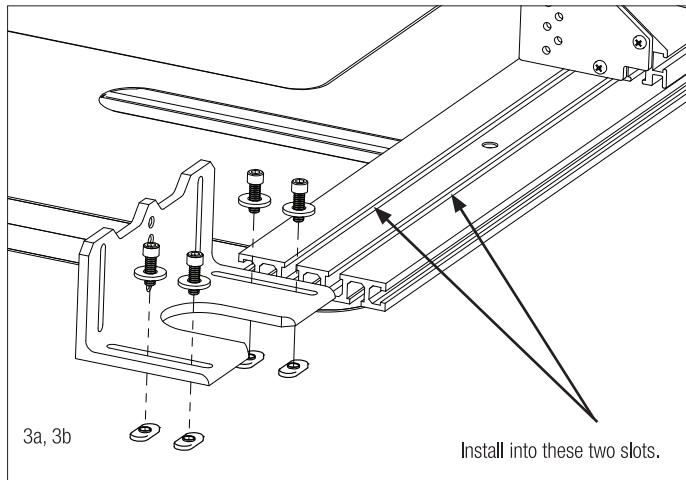

- (3a) Assemble two screws, washer and oval nuts into one of the slots. Repeat for the other slot.
- (3b) Slide the bracket onto the left side of the base fence by aligning both sets of oval nuts with the two T-slots.

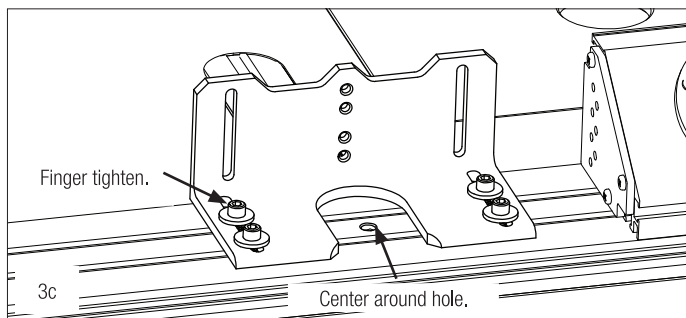

- (3c) Position the bracket so that the large opening is centered over the hole in the base fence. Finger tighten these four screws to prevent the bracket from sliding around.

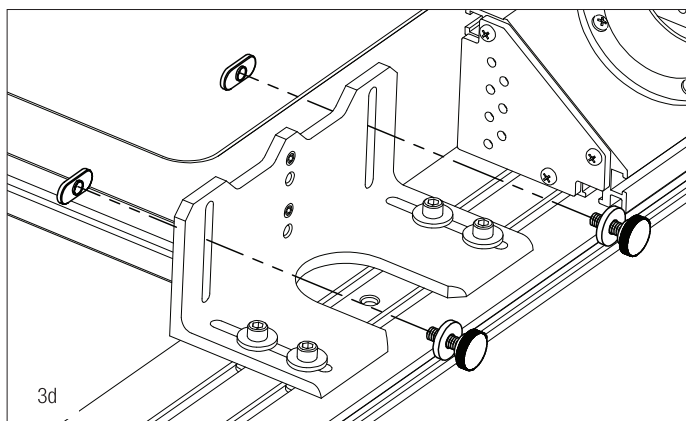

- (3d) Assemble the two knobs, nylon washers and oval nuts into the front two slots as shown.

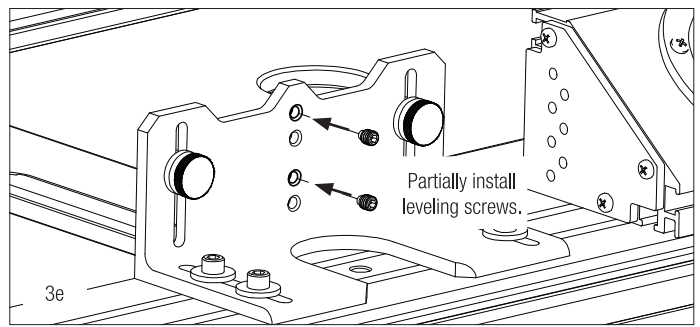

- (3e) Partially install two leveling screws into the holes as shown. Make sure that the screw tips are not protruding from the face of the bracket at this time.

STEP 4: Installing the Offset Plate.

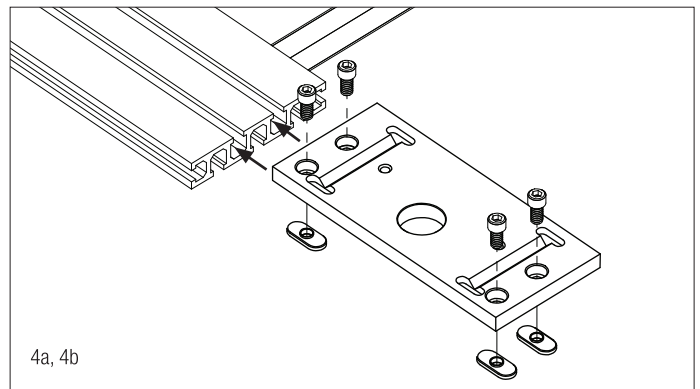

- (4a) Loosely insert the four screws down through each hole of the plate. Start an oval nut on each screw from underneath. Remember to keep all four loose.
- (4b) Slide the plate onto the base by aligning both sets of oval nuts with the T-slots.

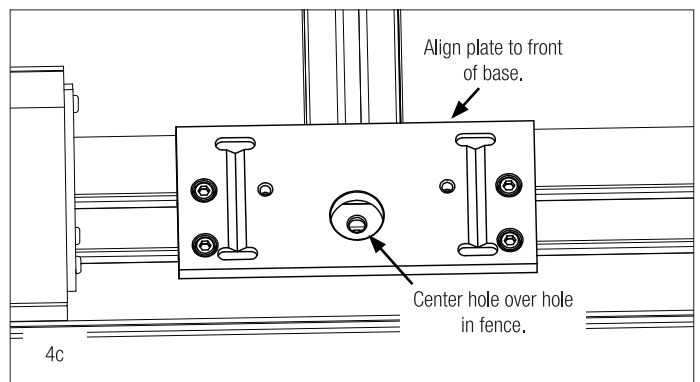

- (4c) Position the plate so that the center hole is over the hole in the fence. Align the front edge of the plate with the front edge of the base fence and just finger tighten the four screws with the included $\frac{3}{16}$ " hex key.

STEP 5: Mounting the Fence to the Table.

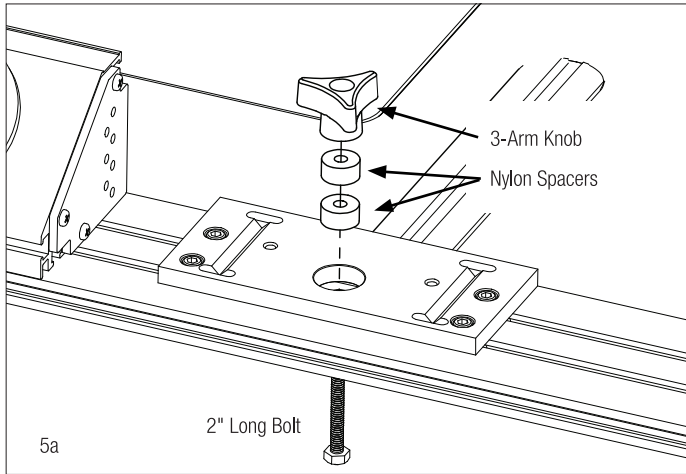

Two different sets of hardware are included. If your table has embedded track, continue with step (5a). If your table has routed slots, skip to step (5c).

(5a) Assemble a 2" long bolt, two nylon spacers and a 3-arm knob through the hole in the outfeed side of the base. Repeat for the matching hole in the infeed side.

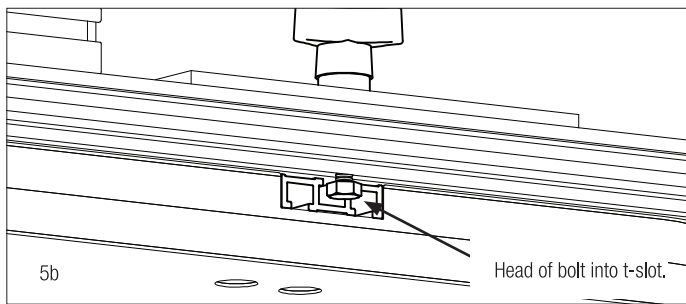

(5b) Align the head of the bolt so it'll slip into the t-slot. Repeat for the bolt on the other end of the fence. Move the fence completely onto the table and tighten the two knobs.

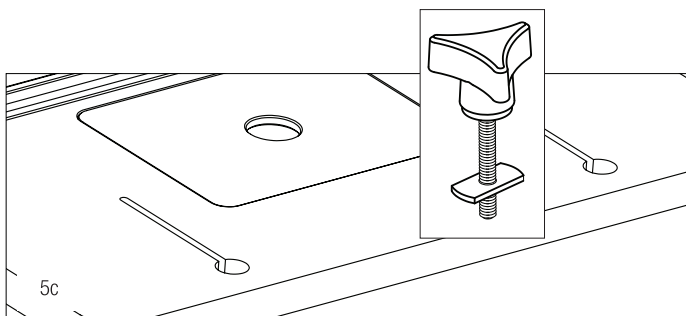

(5c) Steps 5d - 5f are for tables with routed slots. This hardware is different than what's used for tables with embedded track. See illustration above.

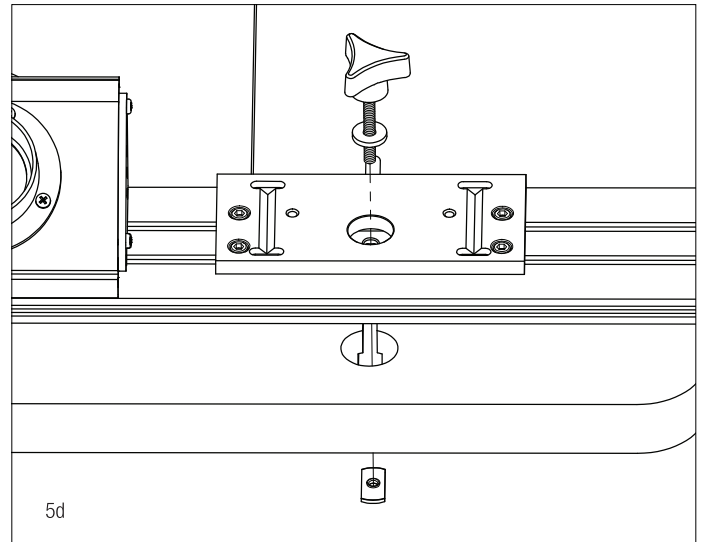

(5d) Assemble hardware as shown.

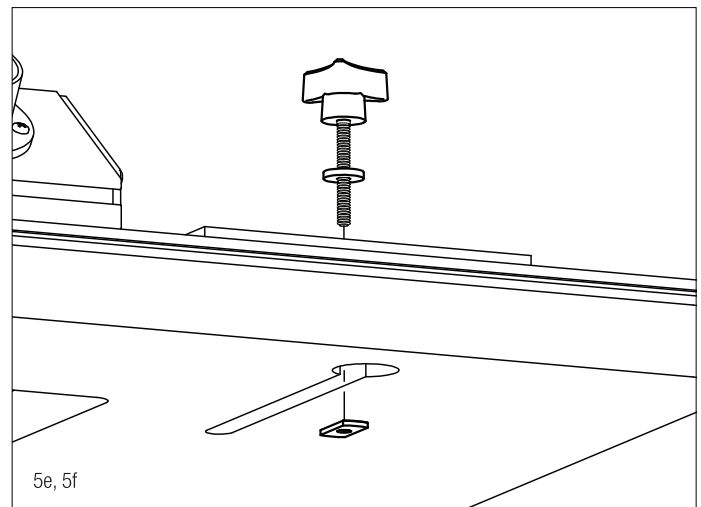

(5e) Set the fence onto the table so that each oval nut drops into its respective hole.

(5f) Reach under the table and align the oval nut with the recess and slide forward. Tighten the two knobs. Repeat this process for the other end of the fence.

Regardless of which mounting approach taken, the fence should now be fastened down to the table.

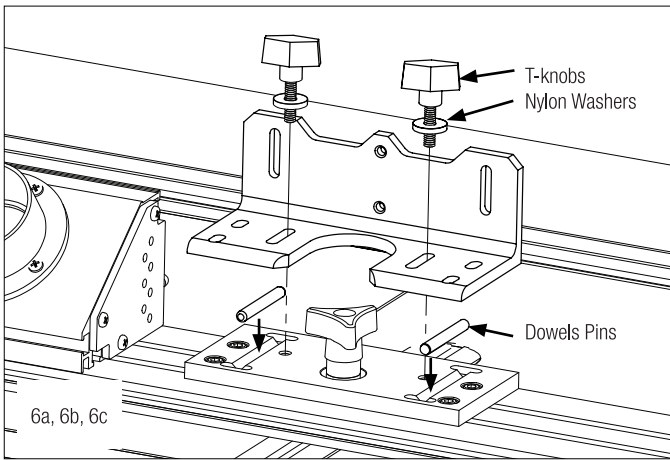

STEP 6: Offset Bracket Assembly.

- (6a) Set two dowel pins into the slots in the offset plate.
- (6b) Set the offset bracket onto the pins. Make sure the grooves in the bottom of the bracket line up with the pins.
- (6c) Secure the bracket in place with the two T-knobs and nylon washers.

STEP 7: Attaching the Outfeed Fence.

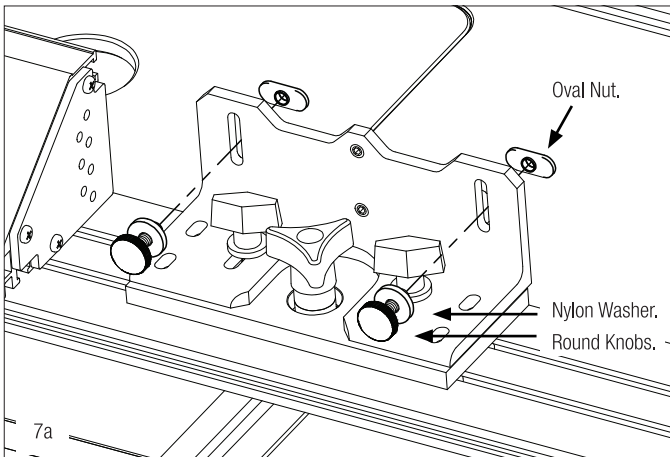

- (7a) Assemble the round knobs, nylon washers and oval nuts through each of the vertical slots.

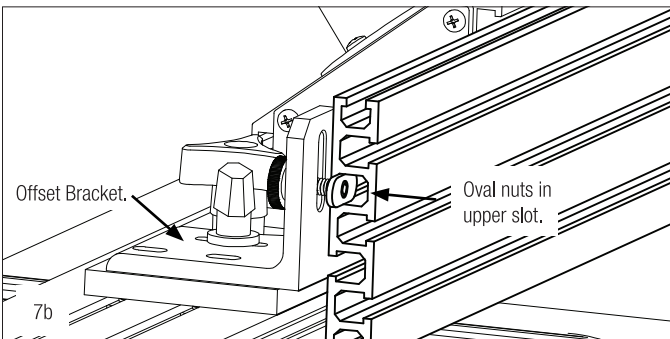

- (7b) With the two-slot side facing the offset bracket, line up the two oval nuts with the upper t-slot. Align the

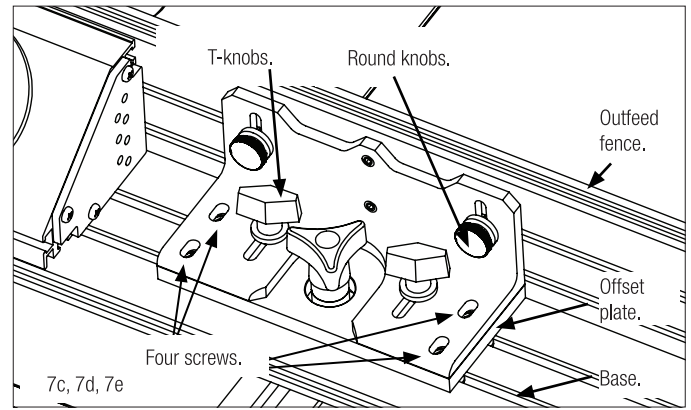

- (7c) Tighten the two round knobs.
- (7d) Make sure the four screws holding the offset plate to the base as well as the two T-knobs are loose.
- (7e) Firmly pull the outfeed fence back against the base. Tighten both T-knobs first then firmly tighten all four screws holding the offset plate to the base fence.

STEP 8: Attaching the Infeed Fence.

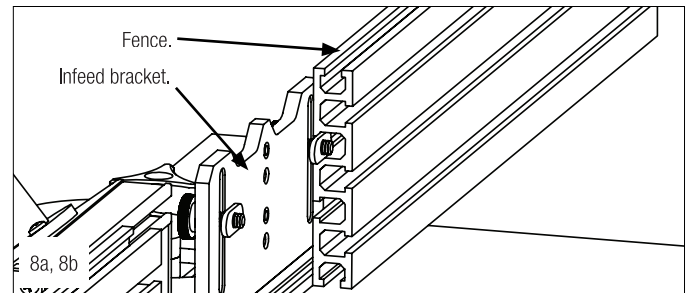

- (8a) Attach the other fence to the infeed bracket the same way the first fence was attached to the offset bracket.
- (8b) Align the end of the fence with the base and firmly tighten both round knobs.

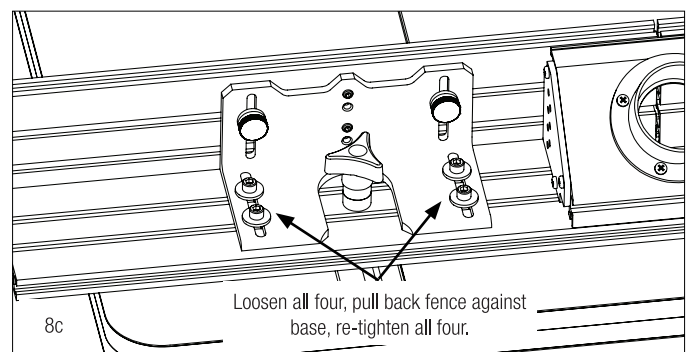

- (8c) Loosen the four screws holding the bracket to the base and pull the fence back against the base. While maintaining pressure, tighten all four bracket screws.

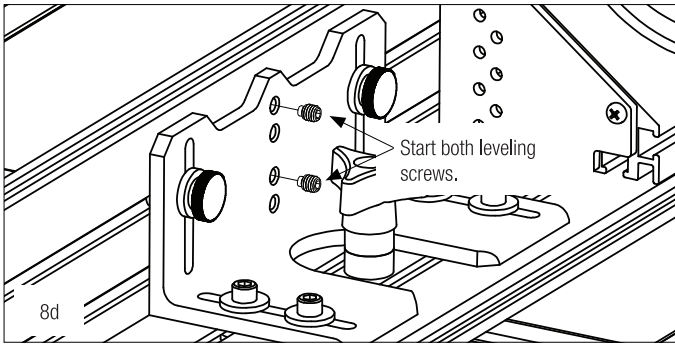

(8d) Partially install both fence leveling screws. These can be adjusted once the fence is mounted to your router table.

STEP 9: Checking for Parallel.

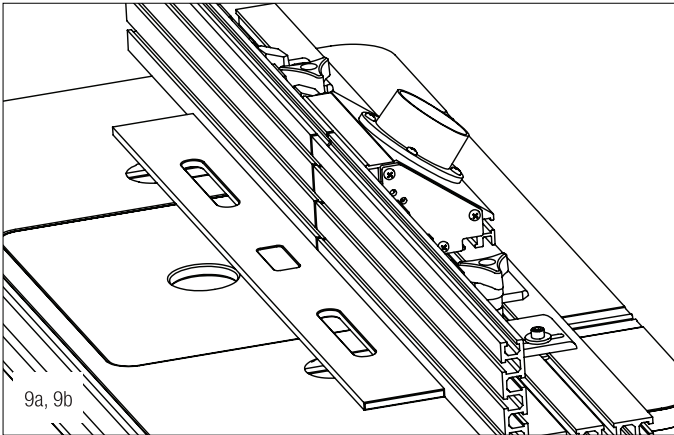

- (9a) Use a reliable straight edge to check that the infeed and outfeed fence are parallel.
- (9b) Adjustments can be made to either infeed or outfeed fences by loosening the four screws in step 7c or 8c, adjusting for parallel and retightening.

This step is critical. If the two fences are not perfectly parallel, it will be impossible to get a straight routed edge.

STEP 11: Attaching Feather Board Track.

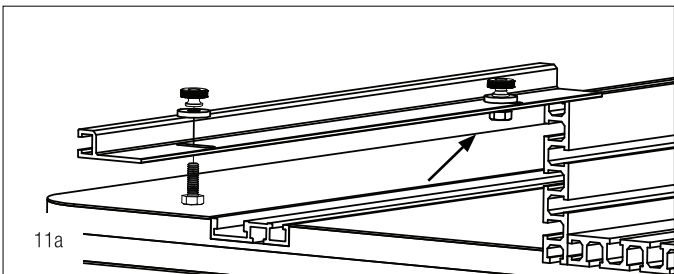

Feather board track can be installed on one or both fences. They are used in instances where a feather board needs to be used along with a sacrificial wooden fence.

- (11a) Each feather board track is attached with two bolts, nylon washers and two black knobs. Assemble the hardware as shown then slip the head of the bolts into the top t-slot. Tighten both knobs.

STEP 12: Attaching a Sacrificial (Sub-Fence).

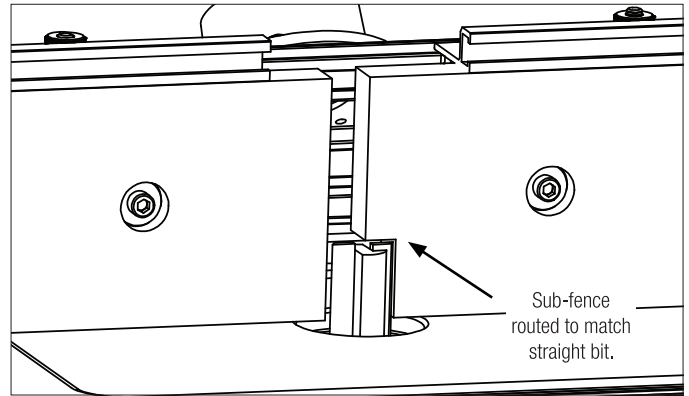

There are a number of purposes for a sacrificial or sub-fence. Most often it's used to create zero clearance at the edges of the router bit. A good fit between the fence and the bit reduces tear out. Illustration 12a and 12b show the dimensions needed to make sub-fences.

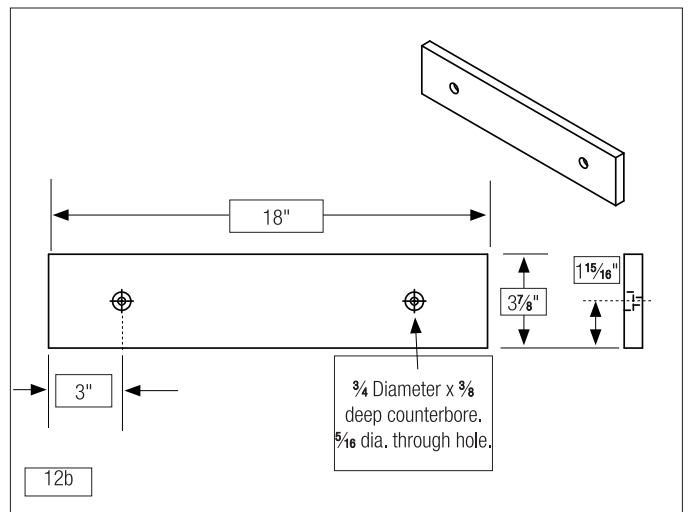
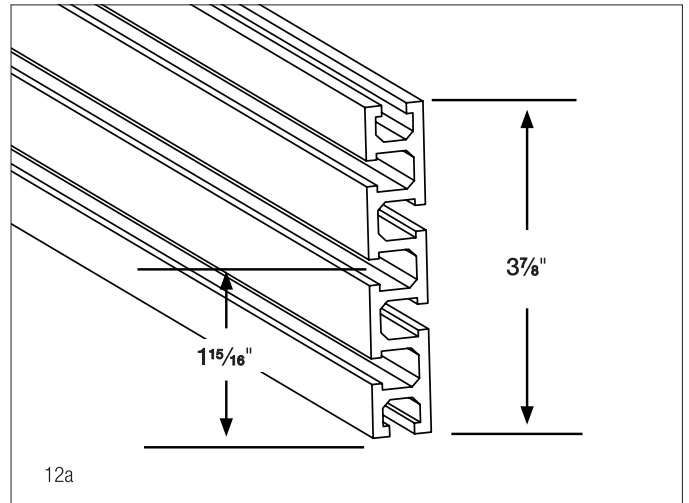

(12b) Use a $\frac{3}{4}$ " thick piece of wood about 18" long and no more than $\frac{3}{8}$ " wide for a sub-fence. First drill two $\frac{3}{4}$ " diameter holes about $\frac{9}{8}$ " deep spaced up from the bottom edge by $1\frac{15}{16}$ " and approximately 3" from each end. This large hole should have a flat bottom. The best way to accomplish that is with a forstner or spade bit.

Once the large hole has been drilled, drill through the rest of the way with a $\frac{5}{16}$ " standard twist drill.

With the sub-fences complete you're ready to install hardware and attach them to the fence.

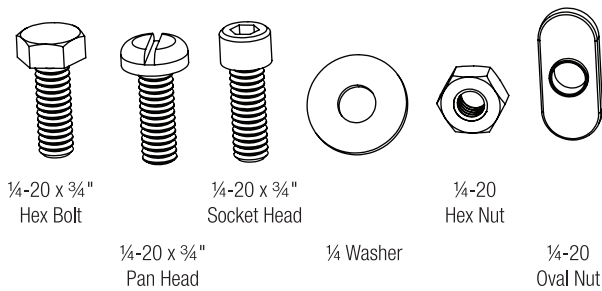

(12c) Here are some examples of hardware that will work. For each sub-fence, you'll need two of any of the screws, two washers and two of either style nut.

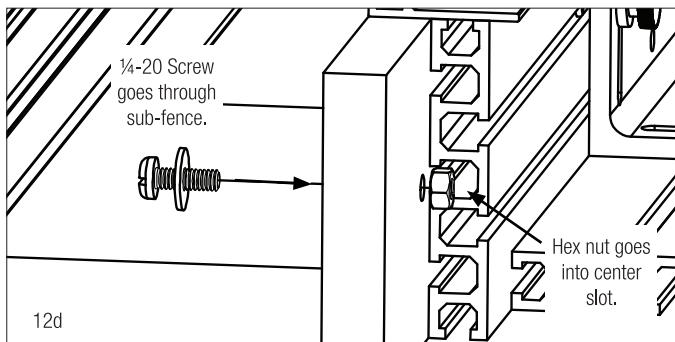

(12d) Loosely install the hardware and slip the nuts into the center t-slot in the face of the aluminum fence. Repeat this for the other fence.

One word about making a zero-clearance fence. Because the router bit spins toward the infeed, only the infeed fence needs to be routed to reduce tear out. In fact leaving the outfeed fence spaced slightly away from the router bit will improve dust collection.

STEP 13: Attaching The Bit Guard.

The bit guard can be attached directly into the slots in the fence or to the slot in the feather board track. In either case, it attaches the same way.

(13a) Pre-assemble the bolts, washers and knobs into each of the two slots.

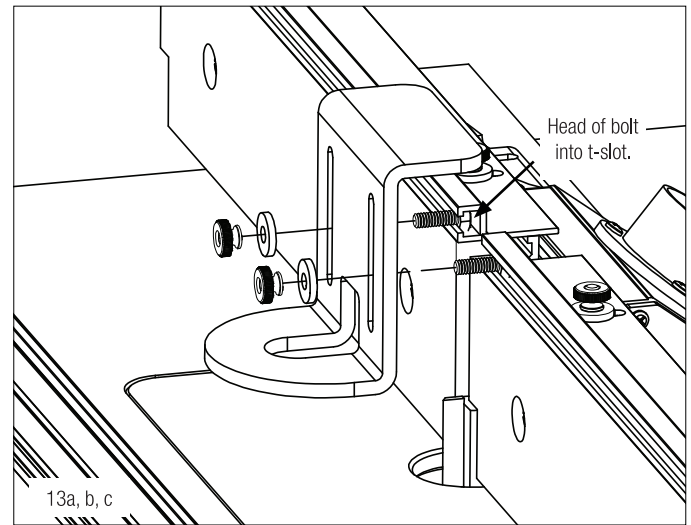

(13b) Slide the head of the bolt into the t-slot in the feather board track or any of the slots in the fence.

(13c) Position the guard in the desired location and tighten both knobs.

Using the Offset Module.

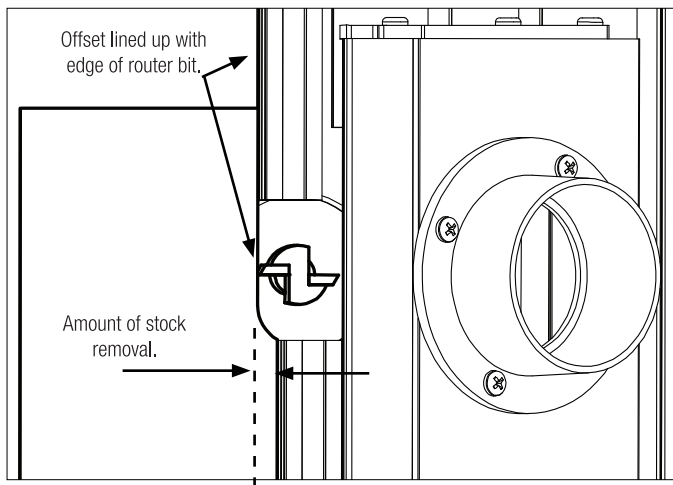

One way to test parallel between the two fences is to set up the fences with an offset then checking the path the board takes as you rout the edge.

Set up the fence so the router bit sits just proud of the in-feed fence. Begin feeding the board across the router bit. Stop feeding the board and turn off the router once the board extends past the bit about 3".

Use the offset module to bring the outfeed fence out until it just touches the new edge of the board.

Retract the board fully away from the router bit. Turn on the router and feed it completely past the router bit.

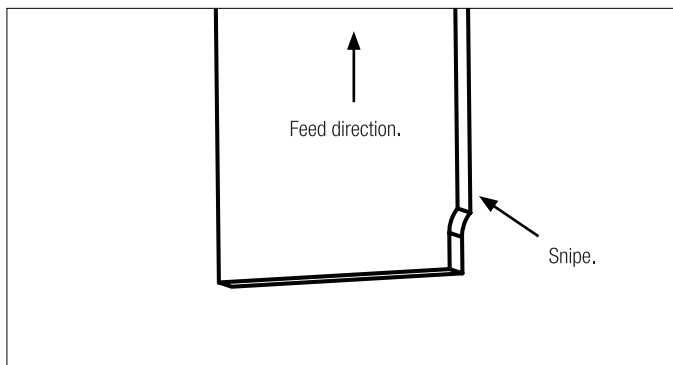

Snipe looks like a small offset at the end of the board which happens when the end slips off the infeed fence and dives into the router bit. This is caused by the outfeed fence being slightly behind the front edge of the router bit.

Correct snipe by adjusting the outfeed fence again so it's lined up with the bit.

Woodpeckers[®]

PRECISION WOODWORKING TOOLS MADE IN USA
Woodpeckers, LLC Strongsville, Ohio · **woodpeck.com**
© 2019 Woodpeckers, LLC



WARNING! This product can expose you to chemicals, including chromium, which is known to the State of California to cause cancer and birth defects or other reproductive harm. For more information go to www.P65Warnings.ca.gov