

Woodpeckers®

DP·PRO

MASTER DRILL PRESS TABLE SYSTEM

OWNER'S MANUAL

Each Sold Separately

Available As

DP·PRO Master System 36/36

DP·PRO Master System 36/24

DP·PRO Master System 48/48

DP·PRO Master System 48/36

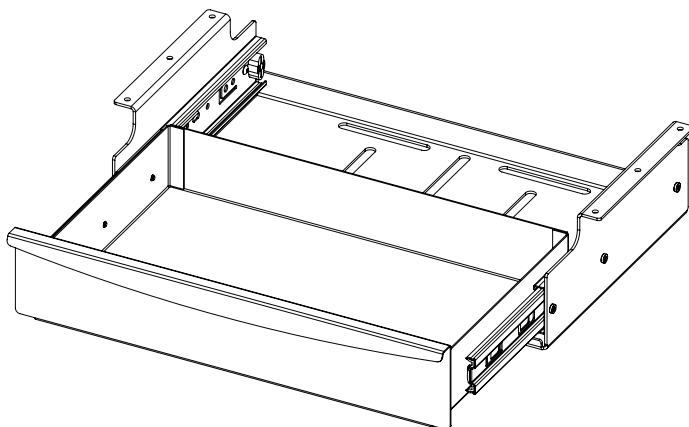
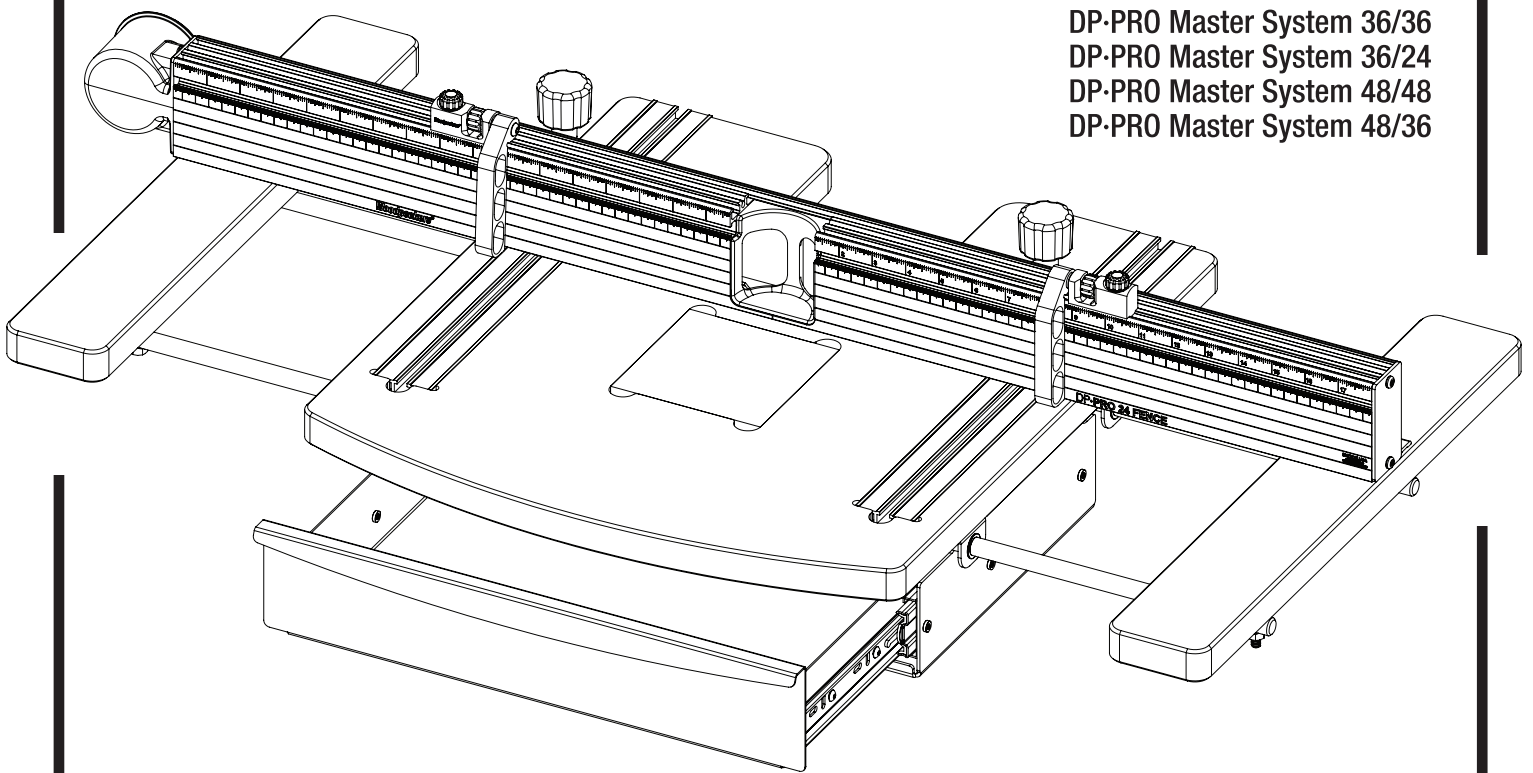

Also Available

DP·PRO Drawer Base

DP·PRO Fence 48

DP·PRO Fence 36

DP·PRO Fence 24

DP·PRO Flip Stop



Scan the QR code above
to watch the video
or visit woodpeck.com
under the video tab towards
the bottom of the product page.

If you think you're missing anything, email us at mailroom@woodpeck.com.
You can also call us at 800-752-0725 from 9:00 a.m. to 4:00 p.m. EST Monday - Friday.

NOTE: Not all the items listed may come with your purchase.

DIAGRAM NUMBER (QTY) PART NAME
TABLE

- ① (1) Table (36" or 48")
- ② (2) Table Extension
- ③ (1) MDF Filler Block
- ④ (2) Red Scale Track
- ⑤ (4) Shaft Bracket
- ⑥ (2) Stainless Steel Shaft (2 Hole)
- ⑦ (2) Stainless Steel Shaft (1 Hole)

HARDWARE BAG A *NOT SHOWN* Red Scale Track

- A-1 (12) 1/4-20 x 3/4" Flathead Philips Screw
- A-2 (12) 1/4 x 20 Oval Nut

HARDWARE BAG B *NOT SHOWN* Table

- B-1 (6) Threaded Stud
- B-2 (12) 1/4-20 Hex Nut
- B-3 (16) #10 Pan Head Phillips Wood Screw
- B-4 (8) Shaft Grommet
- B-5 (4) Retaining Snap Ring
- B-6 (1) 1/8" Allen Key

- ⑧ (2) DP-PRO Flip Stop
- ⑨ (2) Knuckle Clamp

DRAWER

- ⑩ (1) Drawer Base
- ⑪ (1) Drawer

DIAGRAM NUMBER (QTY) PART NAME

HARDWARE BAG C *NOT SHOWN* Drawer Base & Drawer Slides

- C-1 (12) 8-32 x 3/16" Pan Head Screw
- C-2 (2) Drawer Slide (includes Drawer Slide Extension)
- C-3 (6) #10 Pan Head Phillips Wood Screw

HARDWARE BAG D *NOT SHOWN* Drawer Base Mounting to a Drill Press

- D-1 (4) 5/16-18 Large Rectangular Nut
- D-2 (4) 5/16-18 x 3/4" Hex Bolt
- D-3 (4) 5/16-18 x 1-1/4" Hex Bolt
- D-4 (4) 5/16-18 Hex Nut
- D-5 (4) 5/16 Washer
- D-6 (4) 1/4-20 Rectangular Nut
- D-7 (4) 1/4-20 x 3/4" Hex Bolt
- D-8 (4) #10 x 3/8" Phillips Flathead Wood Screw

FENCE

- ⑫ (1) Fence (24", 36" or 48")
- ⑬ (1) Dust Collection Elbow 2-1/4"
- ⑭ (1) Dust Collection Center Chuck Fitting *Already installed.*

HARDWARE BAG E *NOT SHOWN* Fence

- E-1 (1) End Cap
- E-2 (2) Knob
- E-3 (2) 1/4-20 x 3-3/4" Screw
- E-4 (2) Red Tube
- E-5 (4) Nylon Washer
- E-6 (4) 10/32 x 1/2 Pan Head Torx Screw

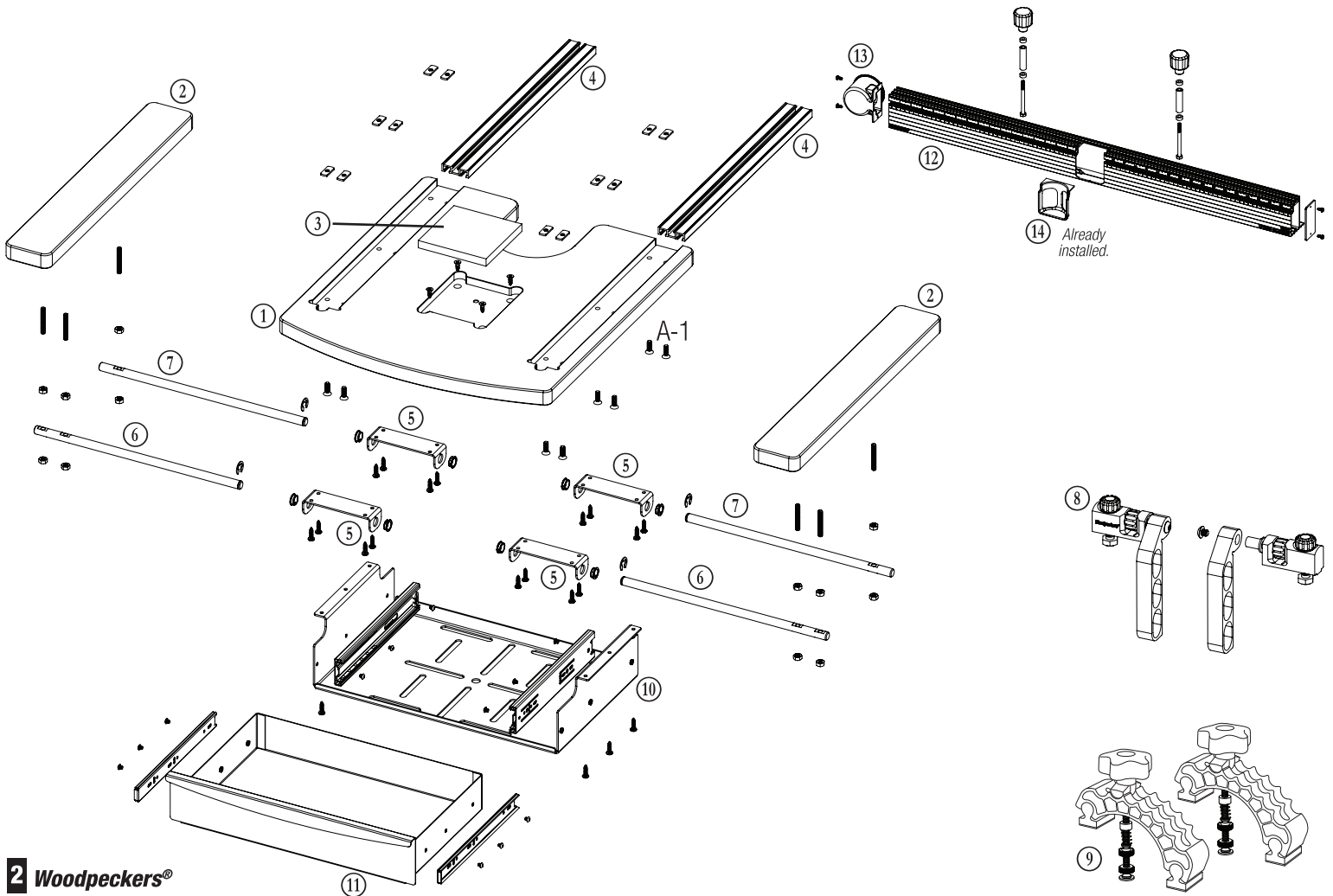

I. ASSEMBLING RED DP-TRACK TO THE TABLE

AT THIS POINT YOU WILL NEED:

- ① (1) Table (36" or 48")
- A-1 (12) 1/4-20 x 3/4" Flathead Phillips Screw
- A-2 (12) 1/4 x 20 Oval Nut
- ④ (2) Red Scale Track

1. Push (12) A-1 Flathead Phillips Screws through the holes on the underside of the ① Table. Thread the Flathead Phillips Screws to the A-2 Oval Nuts just enough to hold them together. **FIGURE 1.**

2. Slide the ④ Red Tracks into the Table's channels. Slide the Red Track so it captures the Oval Nuts. **FIGURE 2.** Slide the Red Track until it stops tight to the front of the channel and is flush to the back of the Table. **FIGURE 3.**

3. Tighten the (12) Flathead Phillips Screws underneath for the Table/Red Track. **DO NOT OVER TIGHTEN THE SCREWS.**

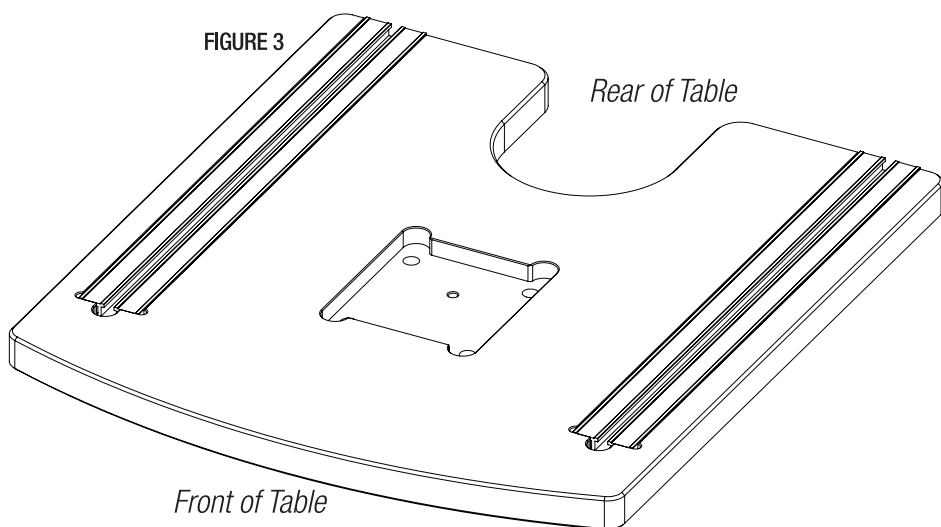
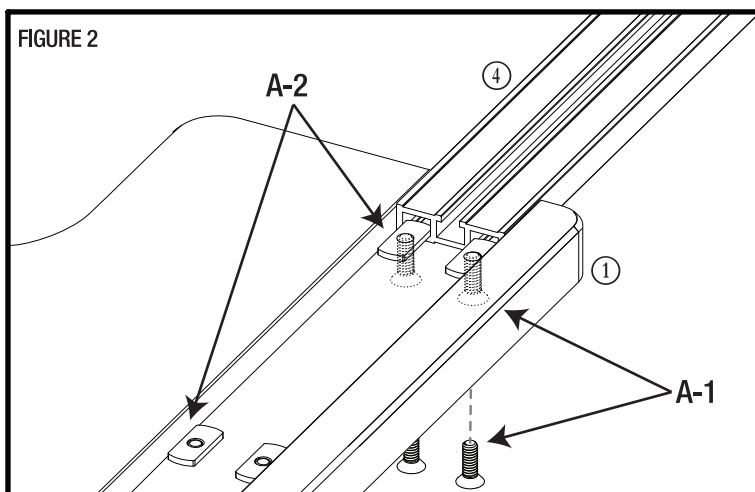
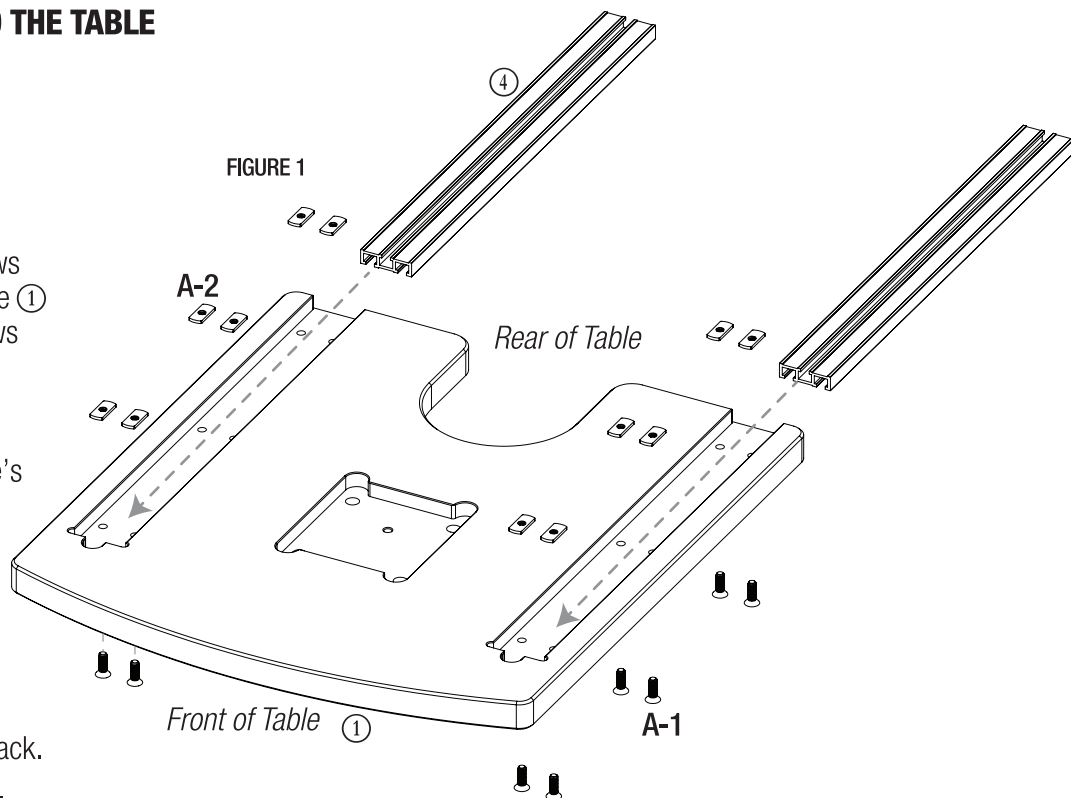

II. ASSEMBLING BRACKETS FOR SIDE EXTENSIONS

AT THIS POINT YOU WILL NEED:

- ⑤ (4) Shaft Bracket
- B-4 (8) Shaft Grommet
- B-3 (16) #10 Pan Head Phillips Wood Screw

1. Squeeze to collapse the B-4 Shaft Grommets then insert them into each end of the ⑤ Shaft Bracket side holes. Do this for all four Shaft Brackets. **Figures 4/4-1.**

2. Locate the mounting holes for the Shaft Bracket on the underside of the ① Table. Screw down the 4 Shaft Brackets to the table using the (16) B-3 Pan Head Phillips Wood Screws. **Figure 5. DO NOT OVER TIGHTEN SCREWS.**

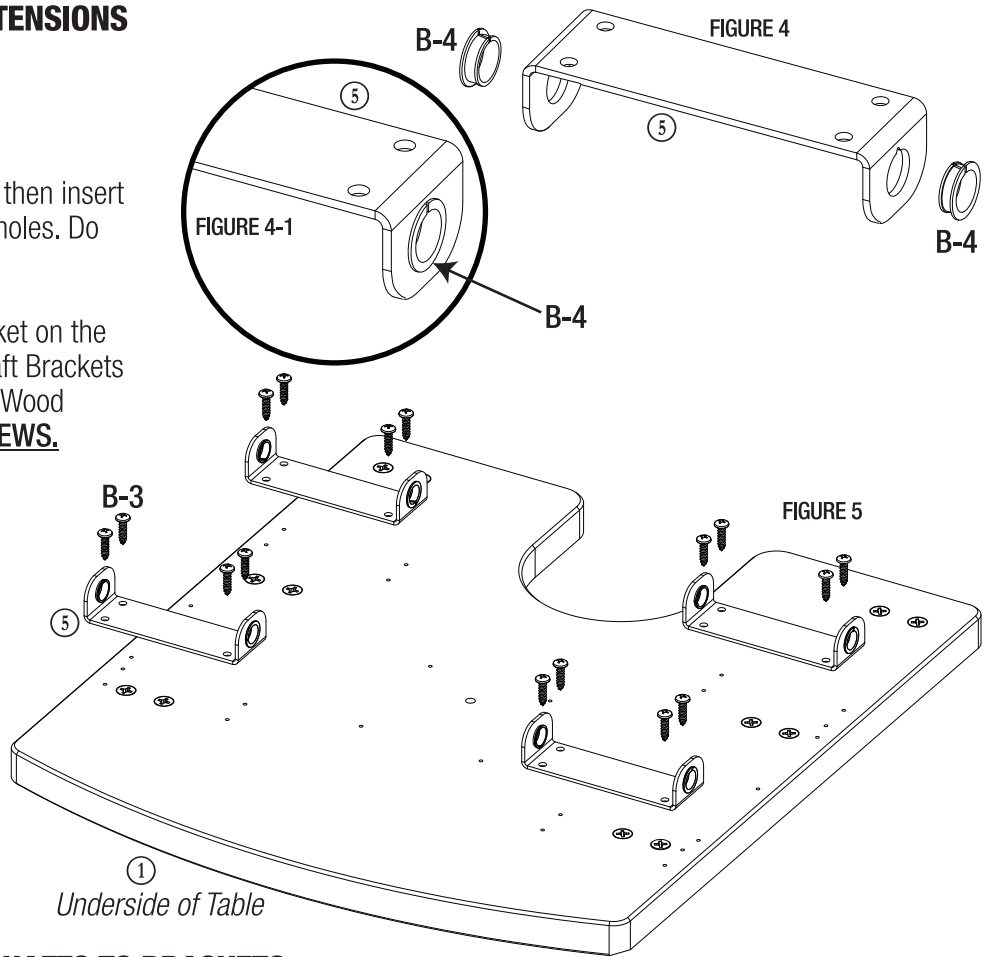

III. ASSEMBLING THE STAINLESS STEEL SHAFTS TO BRACKETS

AT THIS POINT YOU WILL NEED:

- ⑥ (2) Stainless Steel Shaft (2 Hole)
- ⑦ (2) Stainless Steel Shaft (1 Hole)
- B-5 (4) Retaining Snap Ring

1. Slide the (2) ⑥ Stainless Steel Shafts (2 holes) through the front ⑤ Shaft Bracket holes. The holes on the Stainless Steel Shafts should be facing outward from the ① Table, the grooves on the end of the Stainless Steel Shafts should be toward the middle of the Table. **Figure 6.**

2. Slide the (2) ⑦ Stainless Steel Shafts (1 hole) through the rear ⑤ Shaft Bracket holes. The holes on the Stainless Steel Shafts should be facing outward from the Table, the grooves on the end of the Stainless Steel Shafts should be toward the middle of the Table. **Figure 7.**

3. Snap the (4) B-5 Retaining Snap Rings on the grooved end of the Stainless Steel Shafts. **Figures 7/7-1.**

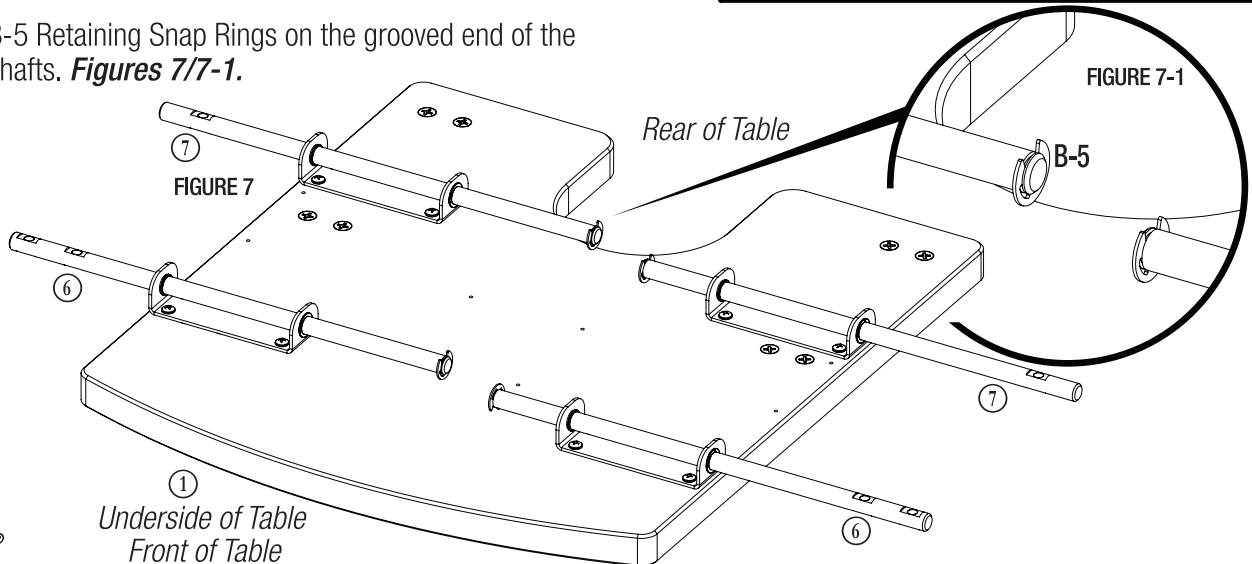

IV. ASSEMBLING THREADED STUDS TO SIDE EXTENSIONS

AT THIS POINT YOU WILL NEED:

- ② (2) Table Extension
- B-1 (6) Threaded Stud
- B-6 (1) 1/8" Allen Key

1. Screw the (6) B-1 Threaded Studs to the ② Table Extensions.

NOTE: One side uses the first sets of holes(A) and the other uses the second sets of holes (B). **Figure 8.**

2. Thread the Threaded Studs into the holes on the Table Extensions with the B-6 Allen Wrench. **NOTE:** Do not install the Threaded Studs too deep. Thread them to about 1-1/8".

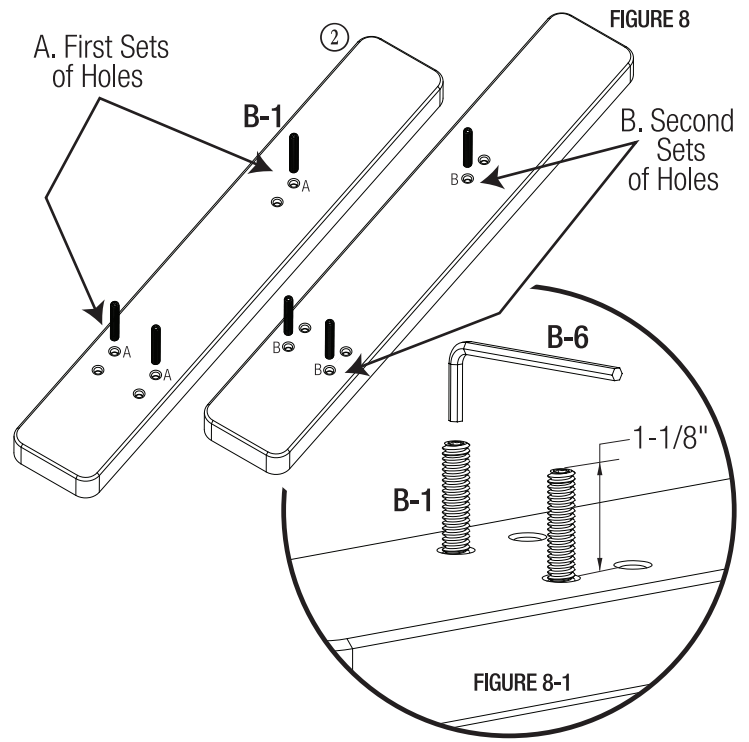

V. ASSEMBLING SIDE EXTENSIONS TO SHAFTS

AT THIS POINT YOU WILL NEED:

- B-2 (12) 1/4-20 Hex Nut

1. Putting the ① Table and ② Table Extensions together on a flat surface will aid in the installation. Install a B-2 Hex Nut onto B-1 Threaded Stud. Thread them down to the bottom of the Threaded Stud just touching the black surface of the Table Extension. **DO NOT TIGHTEN THEM.** **Figure 9.**

2. Raise the Table up and slide the Table Extension with Threaded Studs into to correct Stainless Steel Shaft holes. The Table Extension will fit flush with the back end of the Table. **NOTE:** When the Table Extension is laying next to the Table you will see which Threaded Studs line up with the holes in the Stainless Steel Shaft. **Figure 10.**

3. Install another Hex Nut onto the Threaded Studs until it stops against the Stainless Steel Shaft, finger-tight. **Figure 11.**

4. Turn the bottom Hex Nut counter-clockwise until it stops against the Stainless Steel Shaft, finger-tight. **Figure 11-1.**

NOTE: After the Drawer Base is installed and the Table is turned right-side up, the Table Extensions can be checked to see if they are coplanar with the Table. Adjustments can be made by loosening and tightening these hex nuts.

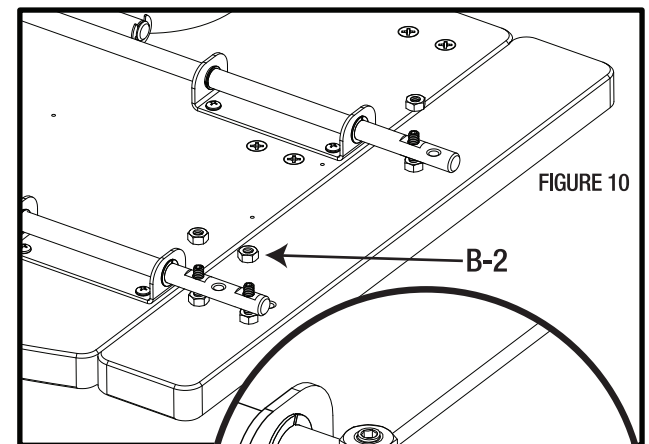
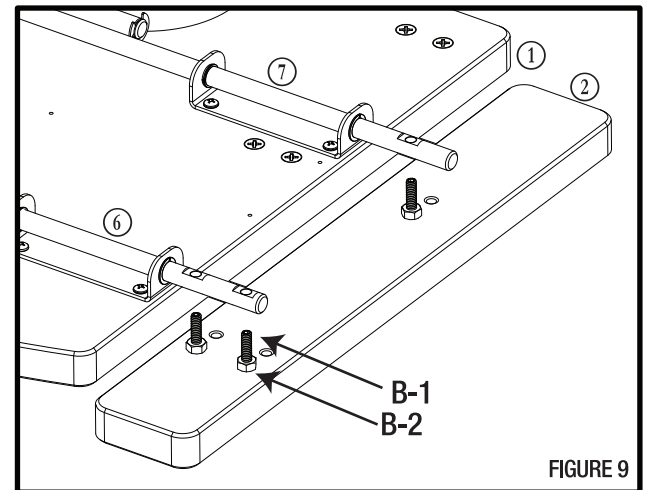

Top Hex Nut
Finger-tight to the
Stainless Steel Shaft

Bottom Hex Nut
Finger-tight to the
Stainless Steel Shaft

FIGURE 11-1

VI. DRAWER ASSEMBLY

AT THIS POINT YOU WILL NEED:

- C-1 (12) 8-32 x 3/16" Pan Head Screw
- C-2 (2) Drawer Slide (includes Drawer Slide Extension)
- ⑩ (1) Drawer Base
- ⑪ (1) Drawer

1. Remove the C-2 Drawer Slide Extension by flexing the end of the Black Plastic Release up or down in direction and pulling away from the Drawer Slide. **Figure 12.**

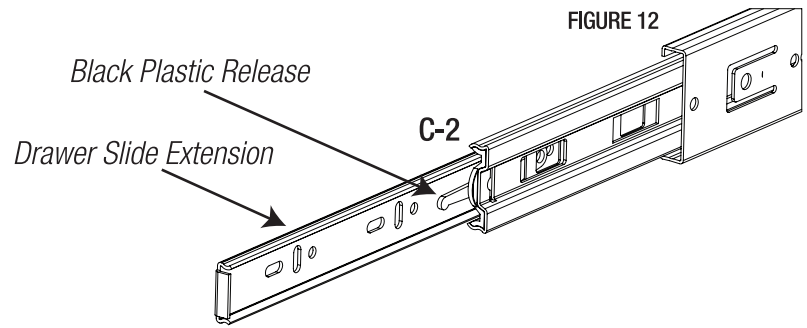

2. Using (3) C-1 Pan Head Screws, attach the Drawer Slide Extension to the Drawer. **NOTE:** Use only the round holes on the Drawer Slide Extension.) **Figure 13.**

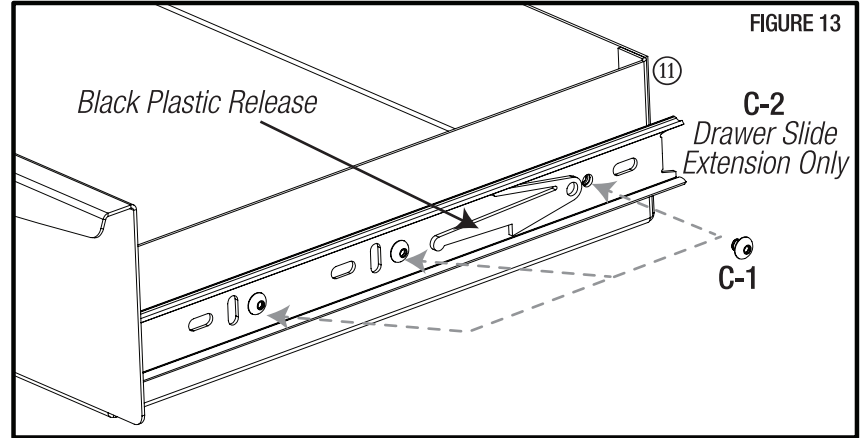

3. Repeat steps 1 & 2 for the other side of the Drawer.

4. Attach the C-2 Drawer Slide to the ⑩ Drawer Base using the (3) C-1 Pan Head Screws. The back of the Drawer Slide has a Black Bumper at the end. The Black Bumper end of the Drawer Slide should be at the back side of the Drawer Base. **NOTE:** Use only the round holes on the Drawer Slide.) **Figures 14/14-1.**

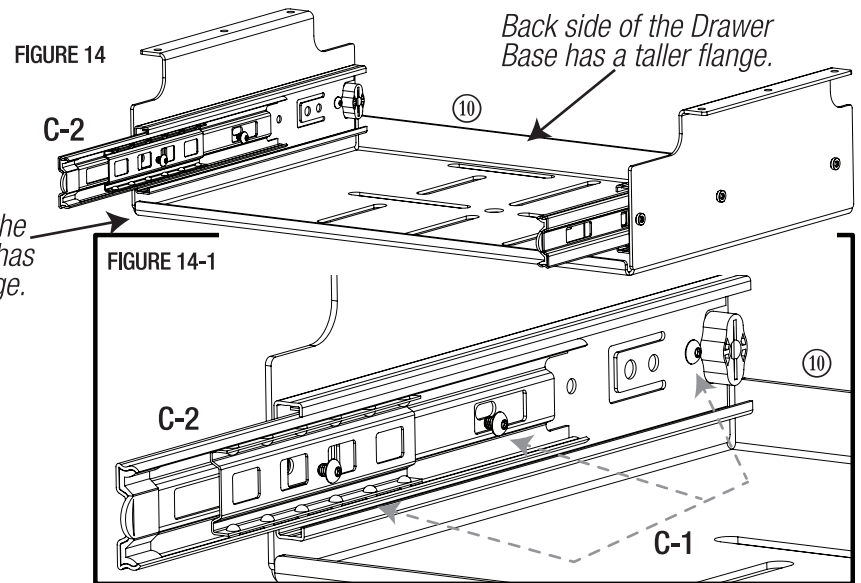

5. Repeat step 4 for the other side of the Drawer Base.

VII. DRAWER BASE ASSEMBLY

AT THIS POINT YOU WILL NEED:

- C-3 (6) #10 Pan Head Phillips Wood Screw

1. Attach the ⑩ Drawer Base to the underside of the ① Table/② Table Extensions Assembly using (3) Pan Head Phillips Wood Screws through each side of the Drawer Base into the Table. **NOTE:** Be certain the back of the Drawer Base is at the rear of the Table. **Figures 15.**

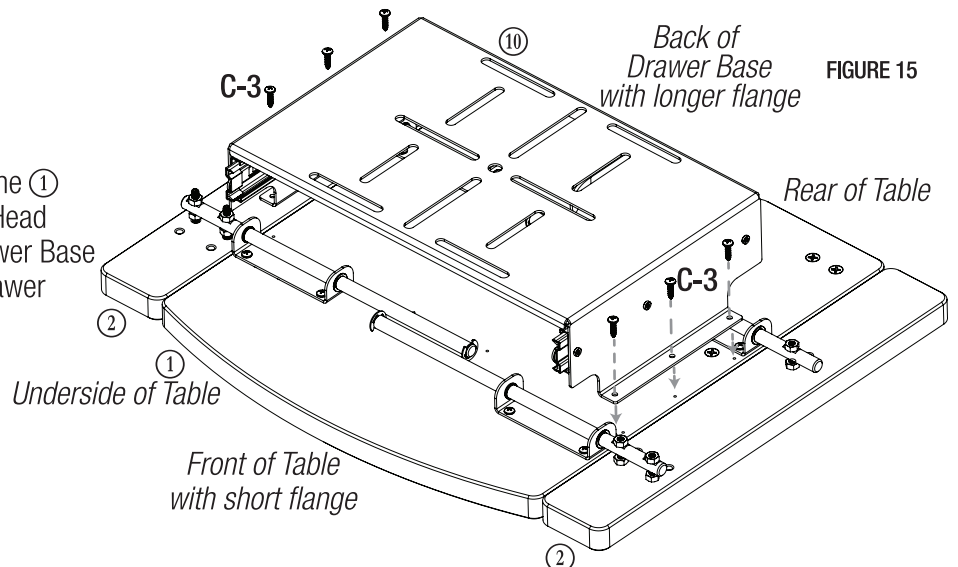

VIII. FENCE INSTALLATION

AT THIS POINT YOU WILL NEED:

- ⑫ (1) Fence (24", 36" or 48")
- ⑬ (1) Dust Collection Elbow 2-1/4"
- ⑭ (1) Dust Collection Center Chuck Fitting
- E-1 (1) End Cap
- E-2 (2) Knob
- E-3 (2) 1/4-20 x 3-3/4" Screw
- E-4 (2) Red Tube
- E-5 (4) Nylon Washer
- E-6 (4) 10/32 x 1/2 Pan Head Torx Screw

1. The ⑬ Dust Collection Elbow and E-1 End Cap can be secured to either end of the ⑫ Fence using the (4) E-6 Pan Head Torx Screws. **Figure 16.**

2. Push the E-3 Screw up through the bottom of the Fence.

Then assemble the E-5 Nylon Washer, E-4 Red Tube and the E-5 Nylon Washer onto the Screw (in that order) securing with the E-2 Knob. **Figure 16-1.**

3. The Fence installs to the ④ Red Track/Table assembly with the E-3 Screw head lined up in the Red Track slot. **Figure 17.**

FIGURE 16

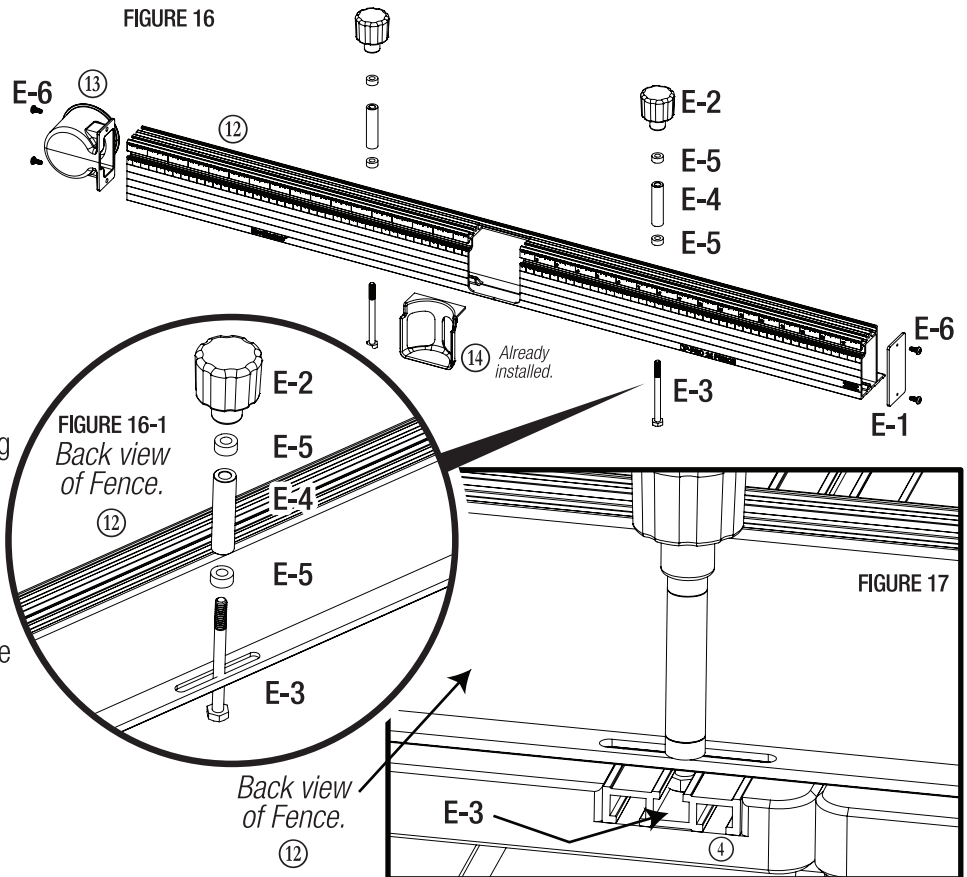

USING THE KNUCKLE CLAMP ⑨

• **T-TRACK COMPATIBILITY:** The Knuckle Clamp is designed to be used with standard 1/4-20 hex head bolts. In the illustration shown, the head of the bolt is captured in a matching aluminum T-track. However the clamp can also be installed in any table with any other 1/4-20 bolt with or without T-track.

For instance in a work bench, a 1/4" carriage bolt can be pushed up through the bench top and used in the same manner. As long as the bolt is secure enough to not pull out, the clamp can do its job. Do not tighten the clamp with anything other than the included Woodpeckers Multi-Knob or similarly sized knob. Do not use a wrench to tighten the clamp. This will destroy the clamp. Hand pressure only.

• **PIVOTING FEET:** Each Pivoting Foot has a Non-Slip Pad molded to it. This Non-Slip Pad prevents marking of softer wood species and greatly reduces movement of the work piece being clamped.

• **HEIGHT KNOB:** The purpose of the Height Knob and Spring is to allow the Knuckle Clamp to rest at a height just above the work piece when clamping pressure is removed. Thus making it easy to slide work under the foot.

• **LOCATION KNOB:** Use the Location Knob to keep the screw vertically oriented and stable. No more than finger pressure is required to keep it in place.

• **BRIDGE:** Although the Bridge has seven different Knuckle locations, only the center five are typically used. A good rule of thumb is to use the one closest to the piece being clamped. This will allow for maximum clamping pressure. Maximum clamping capacity, about 2".

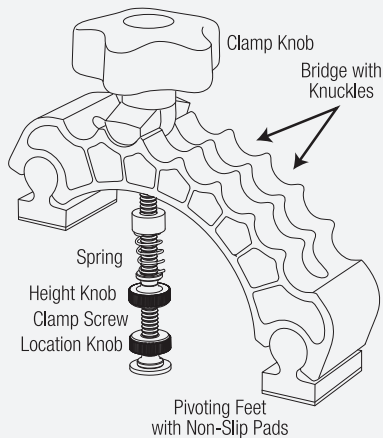

USING THE DP-PRO FLIP STOPS ⑧

• The Flag of the Flip Stop should always be on the chuck side of the stop. Stops to the left of the chuck should have the Flag on the right side of the Flip Stop assembly. Stops to the right of the chuck should have the Flag on the left side of the Flip Stop assembly.

Figure B.

• To reverse a Flip Stop for use on the other side of the chuck, remove the Flag Screw, reverse the Flag and re-install it. **Figure A.**

• Loosen the Locking Thumbwheel and position the stop approximately where you need it. Tighten the Locking Thumbwheel.

• The precise position of the Flag can be fine-tuned using the Micro-Adjust Thumbwheel.

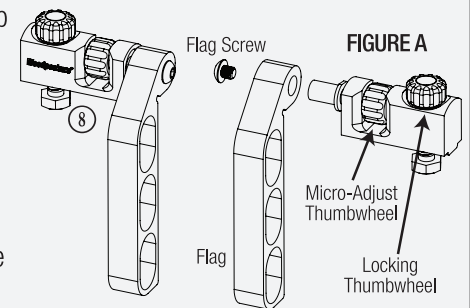

Left of the chuck -
Flag is on the right side
of the Flip Stop assembly.

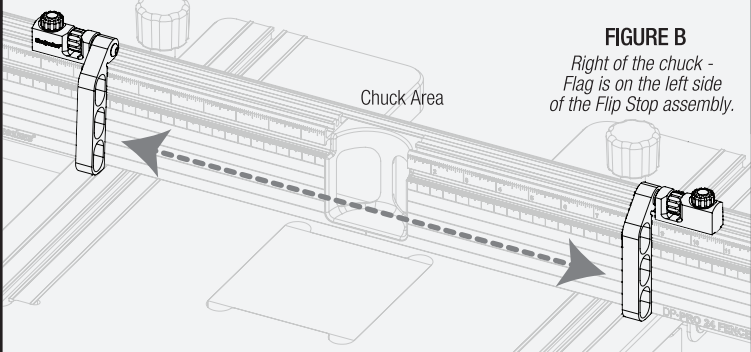

FIGURE B
Right of the chuck -
Flag is on the left side
of the Flip Stop assembly.

IX. MOUNTING

AT THIS POINT YOU WILL NEED:

D-1	(4)	5/16-18 Large Rectangular Nut
D-2	(4)	5/16-18 x 3/4" Hex Bolt
D-3	(4)	5/16-18 x 1-1/4" Hex Bolt
D-4	(4)	5/16-18 Hex Nut
D-5	(4)	5/16 Washer
D-6	(4)	1/4-20 Rectangular Nut
D-7	(4)	1/4-20 x 3/4" Hex Bolt

The DP-PRO Drawer Base has several slots in the Base. The pattern is designed to intersect with virtually any pattern of slots in a factory drill press table. **Figure 18.**

1. The DP-PRO Table has a 1/4" hole at the optimum position for location of the center of the press. Chuck a 1/4" drill bit in your chuck and adjust the table so the drill bit aligns with the hole in the table.

2. Find the outermost points where the slots in the Drawer Base align with the slots in your factory table. These are the optimum points for securing the Drawer Base to your factory table.

3. A variety of hardware has been supplied to attach your DP-PRO table to your factory drill press table. We have supplied two sizes of rectangular nuts.

A. In tables with through-slots, the larger (5/16"-18) should bridge across the slot as shown. **Figure 18/19.**

B. In drill press tables with T-slots, one size or the other should fit the slot as shown. **Figure 20/21.**

IX. ATTACHING THE FILLER BLOCK

AT THIS POINT YOU WILL NEED:

③	(1)	MDF Filler Block
D-8	(4)	#10 x 3/8" Phillips Flathead Wood Screw

1. Install D-8 (4) Phillips Flathead Wood Screw as leveling screws in the table cut-out. Adjust them just about the surface of the machined area. **Figure 22.**

2. Install the Filler Block.

3. Adjust the leveling screws up or down as needed to position the Filler Block flush with the table surface.

FIGURE 18
An example of a drill press table with thru slots.

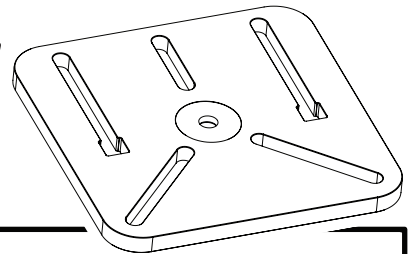

FIGURE 19

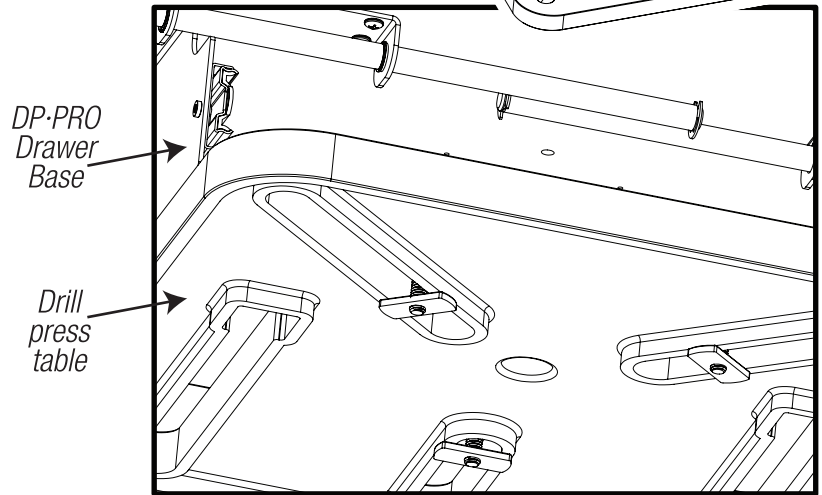

FIGURE 20
An example of a drill press table with T-slots.

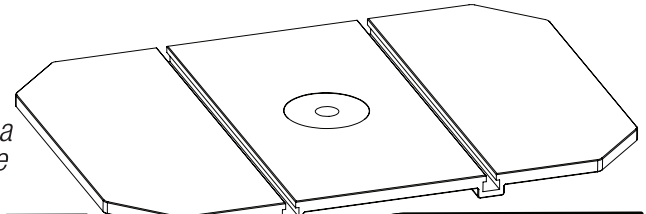
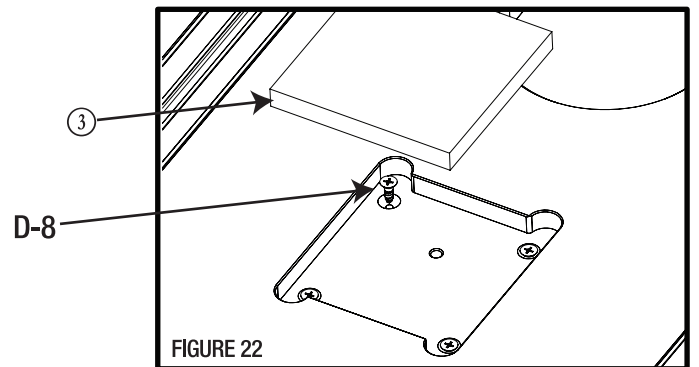
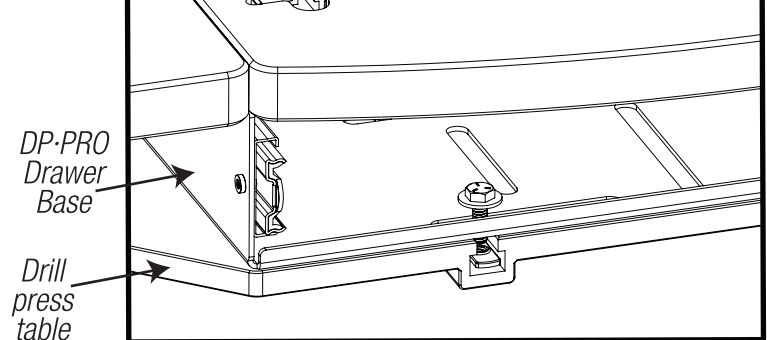

FIGURE 21



Woodpeckers®

PRECISION WOODWORKING TOOLS

Woodpeckers, LLC Strongsville, Ohio · [woodpeck.com](http://www.woodpeck.com)

© 2023 Woodpeckers, LLC



WARNING! This product can expose you to chemicals, including chromium, which is known to the State of California to cause cancer and birth defects or other reproductive harm. For more information go to www.P65Warnings.ca.gov



WARNING! To reduce the risk of injury keep hands away from moving parts. Refer to your drill press manual for proper setup and use.



WARNING! To reduce the risk of injury, wear safety goggles or glasses with side shields, ear protection & a dust mask.